

3-LAYER INSULATED STEEL



TAS-III in white with 24" x 8" windows

For the most demanding commercial environments, the TAS-III offers superior durability and thermal efficiency. Available in a flush panel design, this 3" heavy duty insulated door delivers unmatched performance.



TAS-III interior

PANEL OPTIONS



FLUSH

COLOR OPTIONS

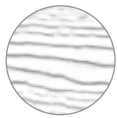

WHITE

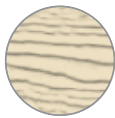

ALMOND

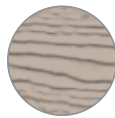

SANDSTONE

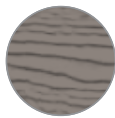

BEIGE



EARTHTONE



SEPIA



BROWN



GREEN

Printed Colors may vary slightly from actual colors. Please visit your local dealer for actual color swatches. Color availability limited to certain door widths. Please contact your North Central Door dealer for more information.

WINDOW OPTIONS



24" X 12"



24" X 8"

CONSTRUCTION

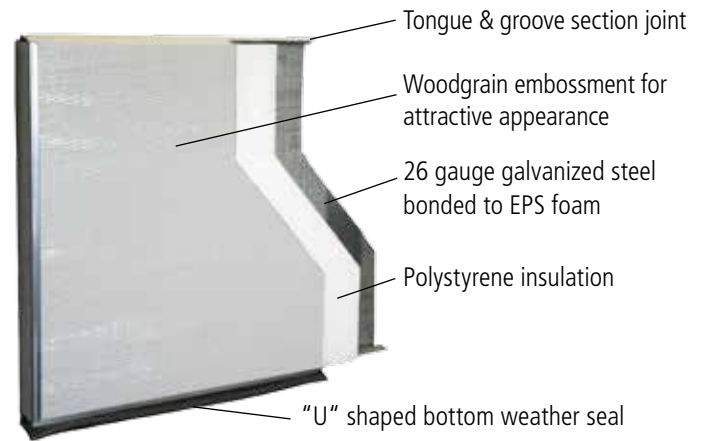

- Strong woodgrain embossed 26 gauge hot-dipped galvanized steel. Pre-finished exterior & interior, then coated with baked-on polyester primer and acrylic finish.
- 3" section thickness with flush panel design.
- Polystyrene insulation bonded to 26 gauge steel skin, providing thermal protection to the edge of each section.
- Tough PVC seal provides continuous thermal break on all sections, reducing thermal transmissions.
- Uniquely designed tongue & groove section joints create a weather-resistant seal against rain, snow and wind.
- 18 gauge hot-dipped galvanized center stiles are recessed, concealed and carried the full height of the section providing superior strength and durability compared to commonly used hinge pads.
- Aluminum bottom weather seal retainer is corrosion resistant.
- Tough "U"-shaped bottom weather seal helps protect against the elements.
- Hinges are 14 gauge-minimum, hot-dipped galvanized steel for lasting durability.
- Optional heavy-duty hardware package available.
- Wind load package available.
- R-value = 15.1.

For complete specifications, visit northcentraldoor.com

Distributed By:



As NCDC continuously strives to improve our products, all specifications listed on this brochure are subject to change without notice or obligation.

NCDC061915



northcentral
DOOR COMPANY

WWW.NORTHCENTRALDOOR.COM